

Trade Area



Trade Area



PHASE II, Q3 2026 DELIVERY

RETAIL A

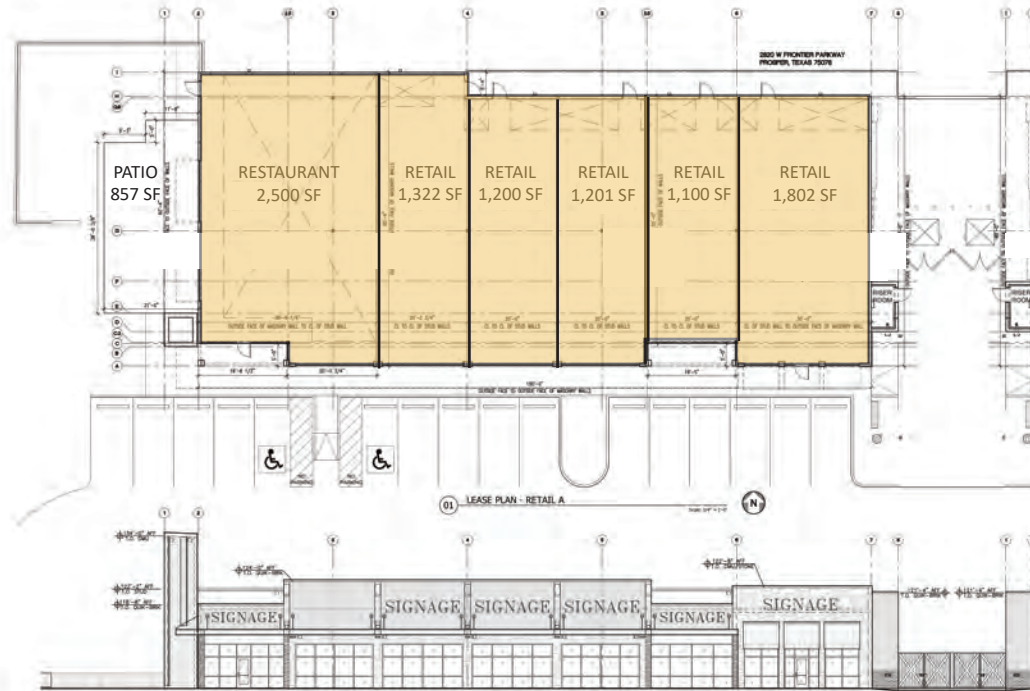

RETAIL B

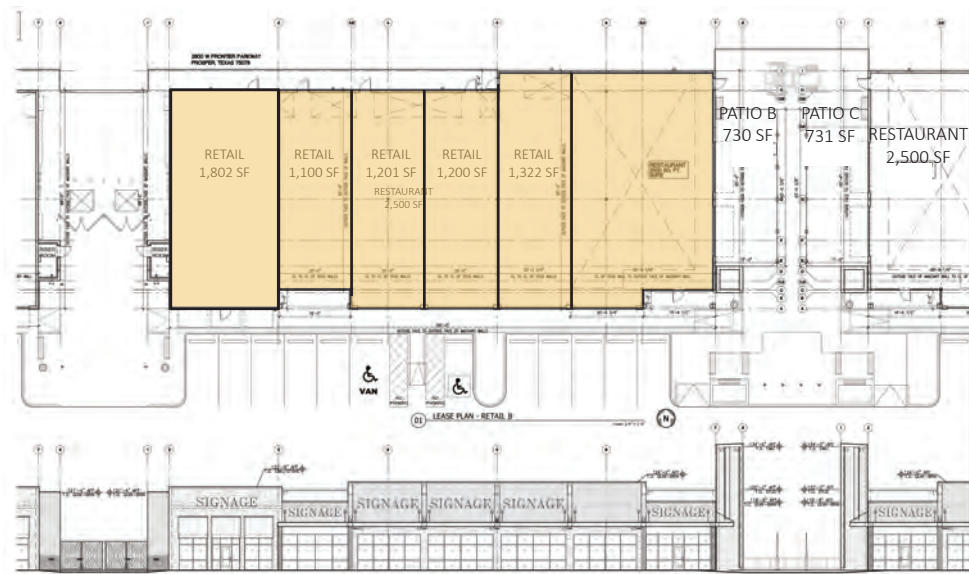

Key

- Available
- At Lease

The information was obtained from sources deemed reliable; however, Weitzman has not verified it and makes no guarantees, warranties or representations as to the completeness or accuracy thereof. The presentation of this real estate information is subject to errors; omissions; change of price; prior sale or lease, or withdrawal without notice. You and your advisors should conduct a careful independent investigation of the property to determine if it is suitable for your intended purpose.

RETAIL C

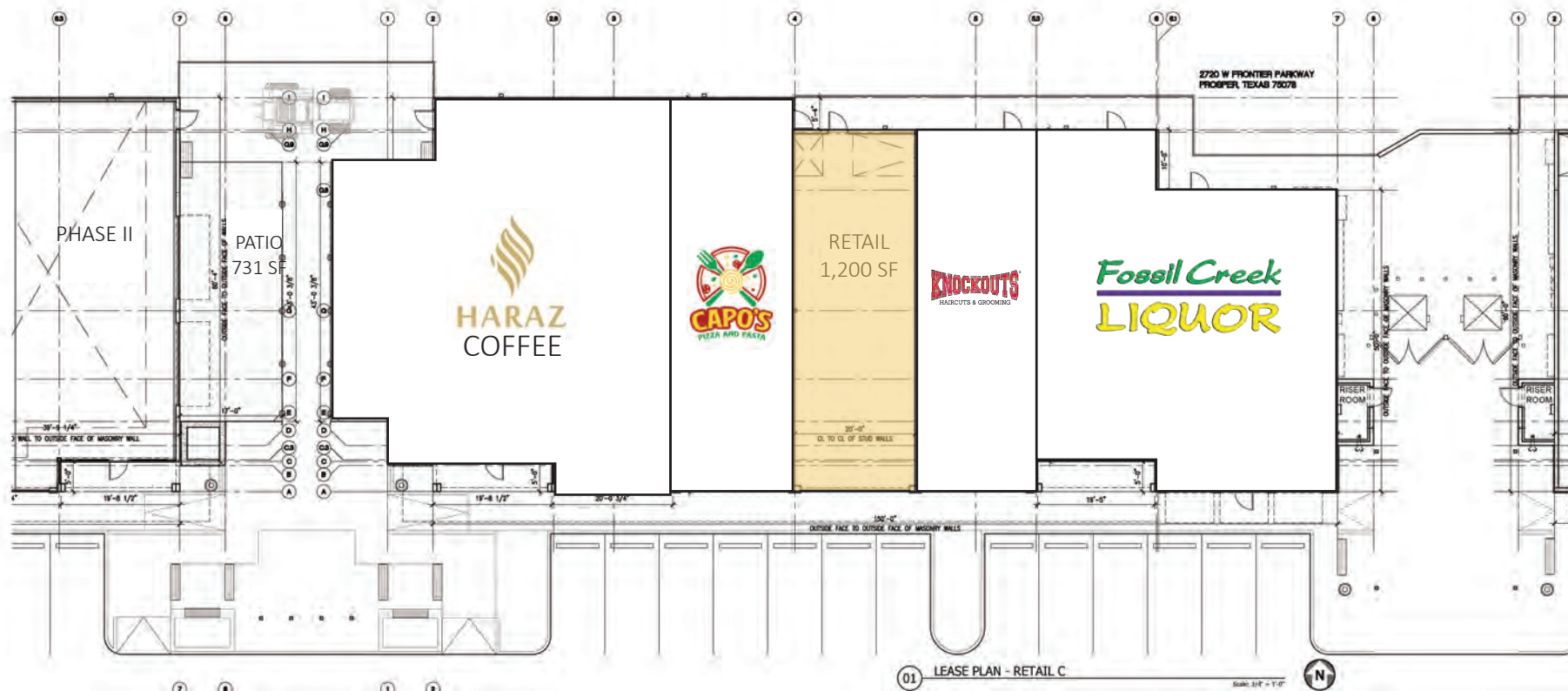

Key	
<span style="display:inline-block; width:15px; height:15px; background-color:yellow; border:1px solid black;"></span>	Available
<span style="display:inline-block; width:15px; height:15px; background-color:orange; border:1px solid black;"></span>	LOI
<span style="display:inline-block; width:15px; height:15px; background-color:green; border:1px solid black;"></span>	At Lease

RETAIL D

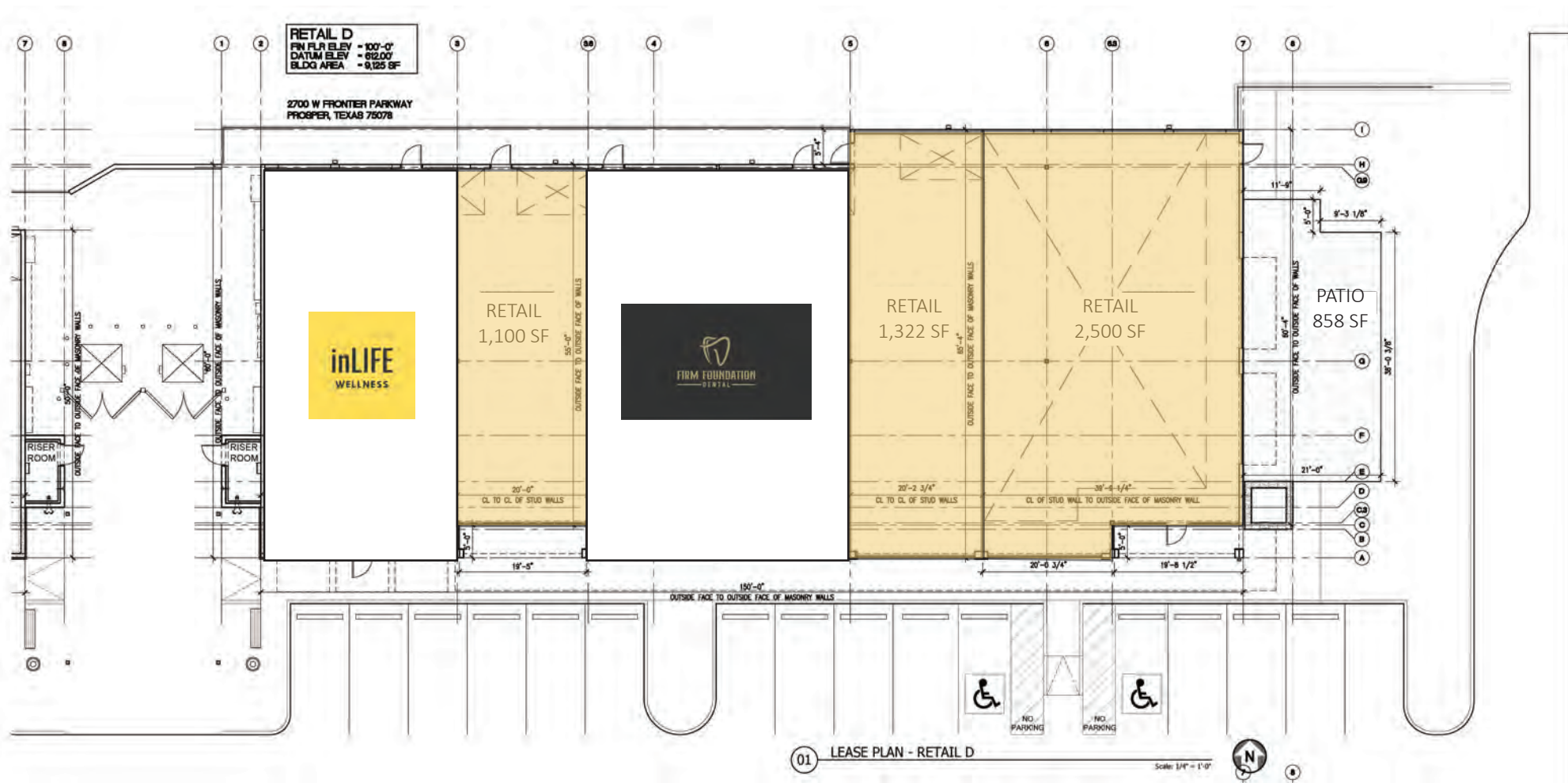

Key	
<span style="display:inline-block; width:15px; height:15px; background-color:yellow; border:1px solid black;"></span>	Available
<span style="display:inline-block; width:15px; height:15px; background-color:orange; border:1px solid black;"></span>	LOI
<span style="display:inline-block; width:15px; height:15px; background-color:green; border:1px solid black;"></span>	At Lease

Current Tenants

100	InLife Wellness	1,802 sf
130	Firm Foundation Dental	2,401 sf

Elevation Study

Retail D



Retail C

